

1/1.8" ~ 4/3" C-MOUNT

HOT

C-MOUNT



C-MOUNT FIXED FA LENSES

These days, C Mount lenses are still the most common type in industrial image processing, esp. in factory automation. Mostly they are used with digital cameras like USB, Fire_Wire, Gig-E and Smart Cameras.

LEM series is an advanced industrial lens product researched and developed by ContrastTech Co., Ltd, which catering to the demands of recent market environment.

The quality of our lens is guaranteed by refined optical glasses, mature coating process and advanced optical structure.

Developed with high cost-performance ratio, the quality and performance are quite competitive with foreign counterparts.

PRODUCT FEATURES

1. Suitable for 5 mega up to 10 mega pixels sensors.
2. High resolution at whole range of WD and excellent brightness.
3. Robust design, suitable for most machine vision applications.
4. Professional MTF optimization
5. Lockable focus and iris screws prevent movement during vibrations or shocks.
6. High cost-performance ratio

Subject to change without prior notice.

For latest specifications and availability, please contact our sales representatives or visit our website: www.contrasttech.com

1/1.8" C-MOUNT FIXED LENSES

Part name	Focal Length (mm)	Aperture (F/#)	M.O.D. (m)	Angle of View (deg.)	TV Distortion (%)	Filter Size	Format (")	Type
LEM0420	4.0	F2.0	0.1	D:94.0° H:82.9° V:66.5°	<0.5%	-	1/1.8"	Standard
LEM0620	6.0	F2.0	0.1	D:64.5° H:54.1° V:41.9°	<0.1%	M25.5× 0.5	1/1.8"	Standard
LEM0820	8.0	F2.0	0.1	D:56.0° H:46.8° V:36.0°	<0.1%	M25.5× 0.5	1/1.8"	Standard
LEM1220	12.0	F2.0	0.1	D:40.7° H:33.0° V:24.3°	<0.3%	M25.5× 0.5	1/1.8"	Standard
LEM1620	16.0	F2.0	0.1	D:30.3° H:24.7° V:18.2°	<0.1%	M25.5× 0.5	1/1.8"	Standard
LEM2520	25.0	F2.0	0.1	D:19.0° H:13.6° V:11.3°	<0.1%	M25.5× 0.5	1/1.8"	Standard
LEM3520	35.0	F2.0	0.2	D:12.24° H:8.8° V:7.0°	<0.1%	M25.5× 0.5	1/1.8"	Standard
LEM5028	50.0	F2.8	0.3	D:10.2° H:8.2° V:6.1°	<0.05%	-	1/1.8"	Standard
LEM7528	75.0	F2.8	0.5	D:5.84° H:5.4° V:4.04°	<0.05%	-	1/1.8"	Standard
LEM0616MP5	6.0	F1.6	0.1	D:71.7° H:60.1° V:46.6°	<0.54%	M34× 0.5	1/1.8"	Standard
LEM01414FE	1.4	F1.4	0.08	D:185° H:185° V:185°	<0.25%	-	1/2"	Fisheye

2/3" C-MOUNT FIXED LENSES

Part name	Focal Length (mm)	Aperture (F/#)	M.O.D. (m)	Angle of View (deg.)	TV Distortion (%)	Filter Size	Mega pixels	Type
LEM0518MP10	5.0	F1.8	0.1	D:95.45° H:66.85° V:82.7°	<5%	M62× 0.75	10	Standard
LEM0814CBMP8	8.0	F1.4	0.1	D:61.7° H:56.3° V:43.7°	<0.1%	M37× 0.5	8	Standard
LEM1216CBMP8	12.0	F1.6	0.15	D:46.6° H:39° V:30.3°	<0.8%	M30.5× 0.5	8	Standard
LEM1614CBMP8	16.0	F1.4	0.3	D:37.3° H:30.3° V:23°	<0.1%	M30.5× 0.5	8	Standard
LEM2514CBMP8	25.0	F1.4	0.3	D:24.6° H:20° V:15°	<0.2%	M30.5× 0.5	8	Standard
LEM3514CBMP8	35.0	F1.4	0.2	D:17.3° H:13.9° V:10.4°	<0.8%	M37× 0.5	8	Standard
LEM5014CBMP8	50.0	F1.4	0.3	D:13.04° H:10.46° V:7.86°	<0.8%	M37× 0.5	8	Standard

1"~1.1" C-MOUNT FIXED LENSES

Part name	Focal Length (mm)	Aperture (F/#)	Range of WD (m)	Angle of View (deg.)	Filter Size	TV Distortion (%)	Mega pixels	Type
LEM7528MP5	75	F2.8	0.6m ~ ∞	11.4°× 9.2°× 4.8°	M34× 0.5	<0.07%	5	Standard
LEM1214CB-H1	12.5	F1.4	0.1m ~ ∞	66.3°× 54.5°× 42°	M46× 0.75	<1.8%	5	Standard
LEM5014CB-H1	50	F1.4	0.3m ~ ∞	17.14°× 13.86°× 10.4°	M46× 0.75	<0.1%	5	Standard
LEM7518CB-H1	75	F1.8	0.7m ~ ∞	12.2°× 9.8°× 7.4°	M55× 0.75	<0.05%	5	Standard
LEM0814CE-H1	8	F1.4	0.2m ~ ∞	88°× 70.5°× 53°	-	<1.5%	5	Standard
LEM1216CE-H1	12	F1.6	1.0m ~ ∞	68.8°× 57.1°× 44.1°	M52× 0.75	<1.5%	5	Standard
LEM1616CE-H1	16	F1.6	1.0m ~ ∞	54.3°× 44.2°× 33.5°	M37× 0.5	<1.0%	5	Standard
LEM2220CE-H1	22	F2.0	0.4m ~ ∞	40°× 32°× 24°	-	<1.0%	5	Standard
LEM2516CE-H1	25	F1.6	1.0m ~ ∞	36.2°× 29.0°× 21.8°	M39× 0.5	<1.0%	5	Standard
LEM3514CE-H1	35	F1.4	1.0m ~ ∞	25.7°× 20.7°× 15.6°	M39× 0.5	<1.0%	5	Standard
LEM0618CBMP9-H1	6	F1.8	0.1m ~ ∞	107.5°× 95.4°× 78.4°	-	<2.3%	9	Standard
LEM0814CBMP9-H1	8	F1.4	0.1m ~ ∞	89.5°× 77.1°× 61.8°	-	<5%	9	Standard
LEM1214CBMP9-H1	12	F1.4	0.1m ~ ∞	64.44°× 53.6°× 41.8°	M40.5× 0.5	<0.5%	9	Standard
LEM1614CBMP9-H1	16	F1.4	0.1m ~ ∞	50.0°× 41.76°× 33.68°	M40.5× 0.5	<0.3%	9	Standard
LEM2514CBMP9-H1	25	F1.4	0.1m ~ ∞	34.94°× 28.7°× 22.06°	M40.5× 0.5	<0.1%	9	Standard
LEM3514CBMP9-H1	35	F1.4	0.15m ~ ∞	23.92°× 19.28°× 14.32°	M40.5× 0.5	<0.1%	9	Standard
LEM5016CBMP9-H1	50	F1.6	0.3m ~ ∞	18.0°× 14.6°× 11.7°	M40.5× 0.5	<0.1%	9	Standard
LEM7518CBMP9-H1	75	F1.8	0.8m ~ ∞	12.2°× 9.8°× 7.4°	M52× 0.75	<0.05%	9	Standard

4/3" C-MOUNT FIXED LENSES

Part name	Focal Length (mm)	Aperture (F/#)	Range of WD (m)	Angle of View (deg.)	Filter Size	Mega pixels	Weight (g)	Type
LEM08528CD-H2	8.5	2.8	0.5m ~ ∞	107.38°× 94.89°× 77.93°	M77× 0.5	12		Standard
LEM1220CD-H2	12	2.0	0.15m ~ ∞	89.02°× 75.46°× 61.08°	M77× 0.75	10	447	Standard
LEM1620CD-H2	16	2.0	0.1m ~ ∞	72.92°× 60.92°× 47.28°	-	10	338	Standard
LEM2520CD-H2	25	2.0	0.15m ~ ∞	49.7°× 40.6°× 31°	M46× 0.75	10	251	Standard
LEM3520CD-H2	35	2.0	0.2m ~ ∞	36.6°× 29.6°× 22.4°	M40.5× 0.5	10	173	Standard
LEM5020CD-H2	50	2.0	0.3m ~ ∞	25.9°× 20.9°× 15.7°	M40.5× 0.5	10	170	Standard

1" C-Mount Fixed Lenses

1. Multi-layer coating technology to effectively prevent glare, ghosting
2. For the 5 Mega-pixels camera
3. High resolution; high contrast
4. Locking set screws for focus and iris Compact Design-diameter
5. Low distortion



LEM1214CB-H1

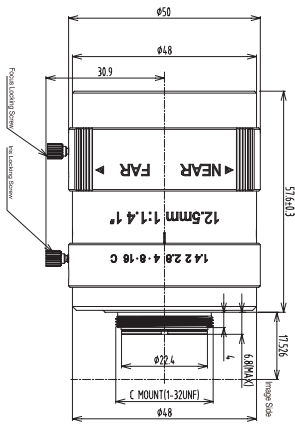

Image Size (inch)	1"
Focal Length (mm)	12.5
Aperture, F/#	1.4~Close
M.O.D.	0.1m
FOV(°)	66.3°×38.5°×42°
Distortion(TV)	1.8%
Flange back	17.526mm in air
Back focus	15.7mm in air
Filter screw size	M46×0.75
Front/Rear Effective Dia.	Front Ø35mm Rear Ø18.8mm
Mount	C-Mount
Temperature Range	-10~+50°C
Storage Temperature Range	-20~+60°C

LEM5014CB-H1

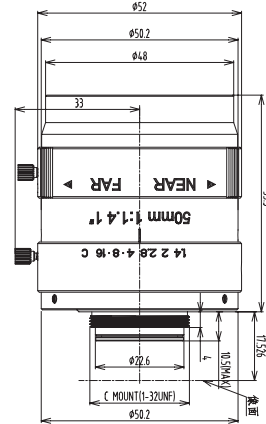

Image Size (inch)	1"
Focal Length (mm)	50.0
Aperture, F/#	1.4~Close
M.O.D.	0.3m
FOV(°)	17.14°×13.86°×10.4°
Distortion(TV)	0.1%
Flange back	17.526mm in air
Back focus	10.5mm in air
Filter screw size	M46×0.75
Front/Rear Effective Dia.	Front Ø30.5mm Rear Ø18mm
Mount	C-Mount
Temperature Range	-10~+50°C
Storage Temperature Range	-20~+60°C

LEM7518CB-H1

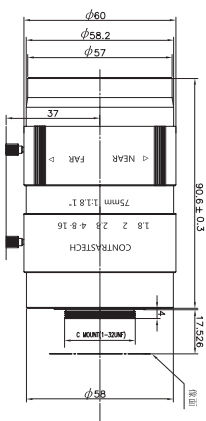

Image Size (inch)	1"
Focal Length (mm)	75.0
Aperture, F/#	1.8~Close
M.O.D.	0.7m
FOV(°)	12.2°×9.8°×7.4°
Distortion(TV)	0.05%
Flange back	17.526mm in air
Back focus	16mm in air
Filter screw size	M55×0.75
Front/Rear Effective Dia.	Front Ø34mm Rear Ø16.5mm
Mount	C-Mount
Temperature Range	-10~+50°C
Storage Temperature Range	-20~+60°C

LEM7528MP5

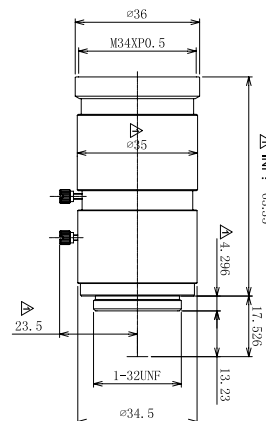

Image Size (inch)	1"
Focal Length (mm)	75.0
Aperture, F/#	2.8~Close
M.O.D.	0.6m
FOV(°)	11.4°×9.2°×6.9°
Distortion(TV)	0.07%
Flange back	17.526mm in air
Back focus	17.69mm in air
Filter screw size	M34×0.5
Front/Rear Effective Dia.	Front Ø29.4mm Rear Ø17.0mm
Mount	C-Mount
Relative Illumination	>97.6%
TTL	79.38mm

LEM1216CE-H1

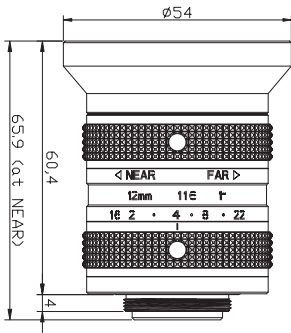

Image Size (inch)	1"
Focal Length (mm)	12.0
Aperture, F/#	1.6~Close
M.O.D.	1m
FOV(°)	68.8°×57.1°×44.1°
Distortion	-2.88%@y=8mm
Flange back	17.526mm in air
Back focus	13.54mm in air
Filter screw size	M52×0.75
Iris	Manual
Mount	C-Mount
Operating Temperature	-10°C~+50°C
Weight	193g

LEM1616CE-H1

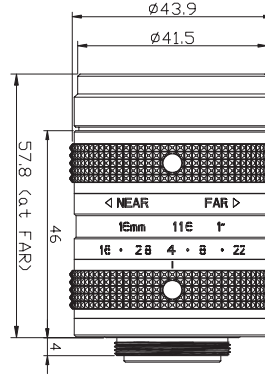

Image Size (inch)	1"
Focal Length (mm)	16.0
Aperture, F/#	1.6~Close
M.O.D.	1m
FOV(°)	54.3°×44.2°×33.5°
Distortion	-3.73%@y=8mm
Flange back	17.526mm in air
Back focus	12.17mm in air
Filter screw size	M37.5×0.5
Iris	Manual
Mount	C-Mount
Operating Temperature	-10°C~+50°C
Weight	202g

LEM2220CE-H1

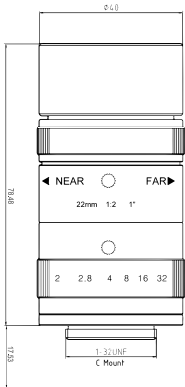

Image Size (inch)	1"
Focal Length (mm)	22.0
Aperture, F/#	2.0~Close
M.O.D.	0.4m
FOV(°)	40°×32°×24°
Distortion (TV)	<1.0%
Flange back	17.526mm in air
Back focus	20.3mm in air
TTL (mm)	93.1
Iris	Manual
Mount	C-Mount
Operating Temperature	-20~+100°C
Weight	220g

LEM2516CE-H1

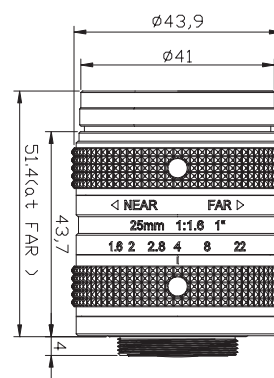

Image Size (inch)	1"
Focal Length (mm)	25.0
Aperture, F/#	1.6~Close
M.O.D.	1m
FOV(°)	36.2°×29.0°×21.8°
Distortion	-2.06%@y=8mm
Flange back	17.526mm in air
Back focus	12.69mm in air
Filter screw size	M39×0.5mm
Iris	Manual
Mount	C-Mount
Operating Temperature	-10°C~+50°C
Weight	157g

LEM3514CE-H1

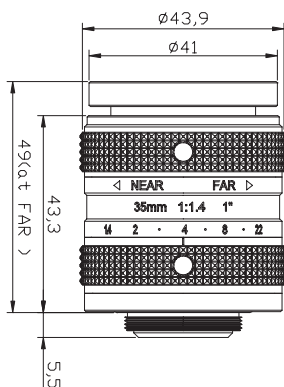

Image Size (inch)	1"
Focal Length (mm)	35.0
Aperture, F/#	1.4~Close
M.O.D.	1m
FOV(°)	25.7°×20.7°×15.6°
Distortion	0.27%@y=8.0mm
Flange back	17.526mm in air
Back focus	12.83mm in air
Filter screw size	M39×0.5mm
Iris	Manual
Mount	C-Mount
Operating Temperature	-10°C~+50°C
Weight	155g